



Industrial Pumps
ISO 9001

2050

Triplex Plunger Pump

Specifications:

Stroke Length: mm (Inches) 75 (2.953)

Pinion Gear

Reduction Ratio 3.15 : 1

Maximum discharge working pressure: bar (psi)

57MM Plunger 96.6 (1400)
54MM Plunger 106.9 (1550)
52MM Plunger 115.5 (1675)
45MM Plunger 154.5 (2240)

Rated power at max. flow and pressure: kw (hp)

2050 Series 52 (70)

Connections:

Suction Port 2.5" NPTF
Discharge Port 1.5" NPTF
Crankshaft Diameter 50 mm

Oil Capacity: liters (gallons)

Crankcase 19.8 -(5.3)

Weight: Kg (lbs)

Pump only 422 (930)

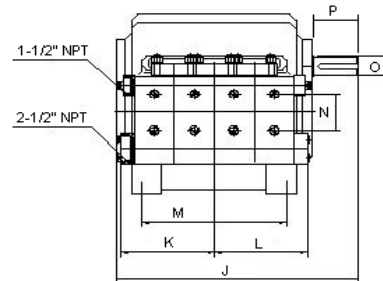
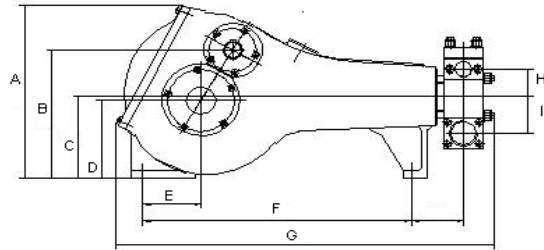

Item	MM	INCHES
A	468.3	18.44
B	346.8	13.65
C	220	8.66
D	210	8.27
E	145	5.71
F	670	26.38
G	943	37.13
H	75	2.9
I	99	3.9
J	601	23.66
K	232.5	9.15
L	232.5	9.15
M	360	14.17
N	100	3.9
O	53.5	2.106
P	110	4.33

Optional Accessories:

- Packing Lubrication
- Positive Power End Lubrication
- Additional plunger sizes available

NOTE: Dimensional information provided as a reference only. Please consult factory for certified drawings.

Plgr. Dia.				Max Pres.		400 RPM		600 RPM		800 RPM		1000 RPM		1200 RPM		1400 RPM		1600 RPM	
mm	in	LPR	GPR	BAR	PSI	LPM	GPM	LPM	GPM	LPM	GPM	LPM	GPM	LPM	GPM	LPM	GPM	LPM	GPM
57	2.244	0.182	0.048	96.6	1400	73	19	109	29	145	38	182	48	218	58	254	67	291	77
54	2.165	0.163	0.043	106.9	1550	65	17	98	26	130	34	163	43	195	52	228	60	260	69
52	2.047	0.151	0.040	115.5	1675	61	16	91	24	121	32	151	40	182	48	212	56	242	64
45	1.772	0.114	0.030	154.5	2240	45	12	68	18	91	24	114	30	136	36	159	42	182	48

*Flows are based on 100% volumetric efficiency.

*Consult factory for continuous speeds in excess of 1250 RPM.

Standard Features:

- * Forged Fluid Cylinder
- * 304 SS Disc Valve Assemblies
- * Colmonoy Coated Plungers
- * Cast Iron Crankcase
- * Forged Steel Crankshaft
- * Heavy Duty Steel Tapered Roller Bearings

$$HP = \frac{(GPM) (PSI)}{1543}$$

$$KW = \frac{(lpm) (bar)}{540}$$

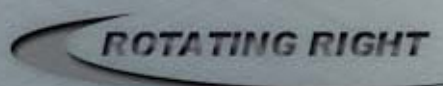

Head Office:
6120 Davies Road
Edmonton, AB
T6E 4M9

Phone: (780) 485-2010 • Toll Free: (866) 707-7867
Fax: (780) 485-1938
• Calgary • Drayton Valley • Lethbridge
www.rotatingright.com