



Weatherford®

**Industrial Pumps
ISO 9001**

2070

Triplex Plunger Pump

Specifications:

Stroke Length: mm (Inches) 100 (3.937)

Pinion Gear

Reduction Ratio 3.15 : 1

Maximum discharge working pressure: bar (psi)

60 MM Plunger	87	(1260)
52 MM Plunger	116	(1675)
48 MM Plunger	138	(2000)
45 MM Plunger	154	(2240)

Rated power at max. flow and pressure: kw (hp)

2070 Series 60 (80)

Connections:

Suction Port	2.5"	NPTF
Discharge Port	1.5"	NPTF
Crankshaft Diameter	50	MM

Oil Capacity: liters (gallons)

Crankcase 19.8 (5.3)

Weight: Kg (lbs)

Pump only 444 (980)

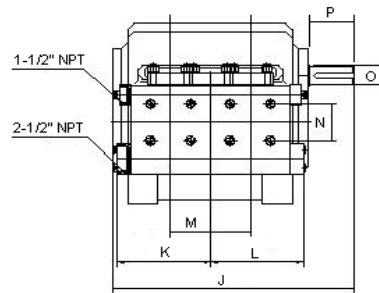
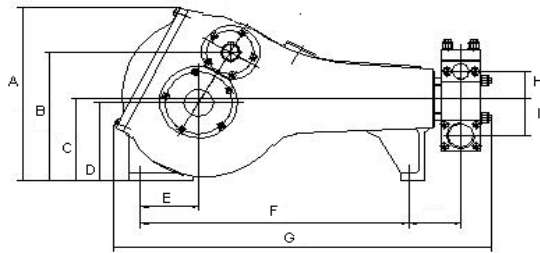

Item	MM	INCHES
A	491.3	19.3
B	369.2	14.5
C	232	9.1
D	222	8.7
E	158	6.2
F	823.1	32.4
G	1126	44.3
H	75	2.9
I	99	3.9
J	604	23.8
K	246	9.7
L	246	9.7
M	100	3.9
N	100	3.9
O	50	1.96
P	110	4.33

Optional Accessories:

- Packing Lubrication
- Positive Power End Lubrication
- Additional plunger sizes available

NOTE: Dimensional information provided as a reference only. Please consult factory for certified drawings.

Plgr. Dia.				Max Pres.		400 RPM		600 RPM		800 RPM		1000 RPM		1200 RPM		1400 RPM	
mm	in	LPR	GPR	BAR	PSI	LPM	GPM	LPM	GPM	LPM	GPM	LPM	GPM	LPM	GPM	LPM	GPM
60	2.362	0.2690	0.0711	87	1260	108	28	161	43	215	57	269	71	323	85	377	100
52	2.047	0.2000	0.0530	116	1675	80	21	120	32	160	42	200	53	240	64	280	74
48	1.890	0.1718	0.0454	138	2000	69	18	103	27	137	36	172	45	206	54	241	64
45	1.772	0.1513	0.0400	154	2240	61	16	91	24	121	32	151	40	182	48	212	56

*Flows are based on 100% volumetric efficiency.

*Consult factory for continuous speeds in excess of 1100 RPM.

Standard Features:

- * Forged Fluid Cylinder
- * 304 SS Disc Valve Assemblies
- * Colmonoy Coated Plungers
- * Cast Iron Crankcase
- * Forged Steel Crankshaft And Pinion Shaft
- * Heavy Duty Steel Tapered Roller Bearings

$$HP = \frac{(GPM) (PSI)}{1543}$$

$$KW = \frac{(lpm) (bar)}{540}$$



Head Office:
6120 Davies Road
Edmonton, AB
T6E 4M9

Phone: (780) 485-2010 • Toll Free: (866) 707-7867
Fax: (780) 485-1938
• Calgary • Drayton Valley • Lethbridge
www.rotatingright.com