



Weatherford®

Industrial Pumps
ISO 9001

2070SC

Triplex Plunger Pump

Specifications:

Stroke Length: mm (Inches) 100 (3.937)

Pinion Gear

Reduction Ratio 3.15 : 1

Maximum discharge working pressure: bar (psi)

60 MM Plunger	138	(2000)
52 MM Plunger	184	(2667)
48 MM Plunger	215	(3122)
45 MM Plunger	245	(3555)

Rated power at max. flow and pressure: kw (hp)

2070SC Series 124 (166)

Flange Connections:

Suction Port	2.5"	NPTF
Discharge Port	1.5"	NPTF
Crankshaft Diameter	50	MM

Oil Capacity: liters (gallons)

Crankcase 19.8 (5.3)

Weight: Kg (lbs)

Pump only 444 (980)

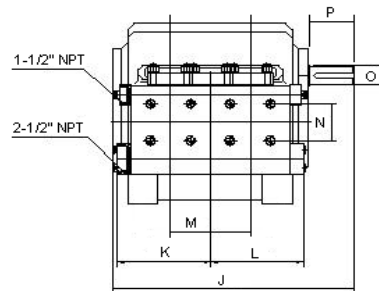
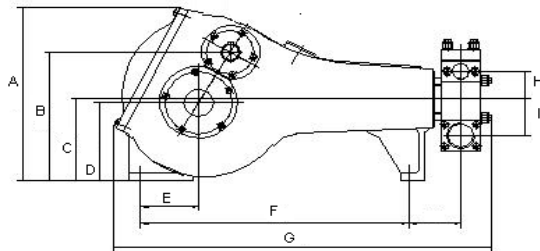

Item	MM	INCHES
A	491.3	19.3
B	369.2	14.5
C	232	9.1
D	222	8.7
E	158	6.2
F	823.1	32.4
G	1126	44.3
H	75	2.9
I	99	3.9
J	604	23.8
K	246	9.7
L	246	9.7
M	100	3.9
N	100	3.9
O	50	1.96
P	110	4.33

Optional Accessories:

SAE 'C' spline crankshaft

NOTE: Dimensional information provided as a reference only.
Please consult factory for certified drawings.

Plgr. Dia.	mm	in	LPR	GPR	Max Pres.		1550 RPM		1600 RPM		1650 RPM		1700 RPM		1750 RPM		1800 RPM	
					BAR	PSI	LPM	GPM	LPM	GPM	LPM	GPM	LPM	GPM	LPM	GPM	LPM	GPM
60	2.362	0.2690	0.0711	138	2000	416	110	431	114	443	117	458	121	473	125	484	128	
52	2.047	0.2000	0.0530	184	2667	314	83	325	86	333	88	344	91	357	94	363	96	
48	1.890	0.1718	0.0454	215	3122	265	70	276	73	284	75	291	77	299	79	310	82	
45	1.772	0.1513	0.0400	245	3555	235	62	242	64	250	66	257	68	265	70	272	72	

*Flows are based on 100% volumetric efficiency.

Features:

- * Forged Carbon Steel Fluid Cylinder
- * 304 SS Disc Valve Assemblies
- * Colmonoy Coated Plungers
- * Cast Iron Crankcase
- * Forged Steel Crankshaft And Pinion Shaft
- * Heavy Duty Steel Tapered Roller Bearings

$$HP = \frac{(GPM) (PSI)}{1543}$$

$$KW = \frac{(lpm) (bar)}{540}$$



Head Office:
6120 Davies Road
Edmonton, AB
T6E 4M9

Phone: (780) 485-2010 • Toll Free: (866) 707-7867
Fax: (780) 485-1938
• Calgary • Drayton Valley • Lloydminster
www.rotatingright.com